

SPECIFICATIONS		
Description	CPAP Cleaner	
Model	Sani Bot D6	
Tank Capacity	6000 ml 1.6 gallon (US)	Max.5000 ml / 1.3 gallon (US)
		Min.3350 ml / 0.9 gallon (US)
Tank Size	32.3 x 20.5 x 9.9 cm / 12.7" x 8.1" x 3.9"	
Longest Item Fits inside Tank	34.0 cm / 13.4"	
Power	420 W (AC 100~120 V 60 Hz)	
Digital Timer	1 to 30-minute full range timer	
Temperature Settings	□>104°F → 113°F → 122°F → 131°F → 140°F□	

Sani Bot D6

CPAP Mask Cleaner

USER MANUAL

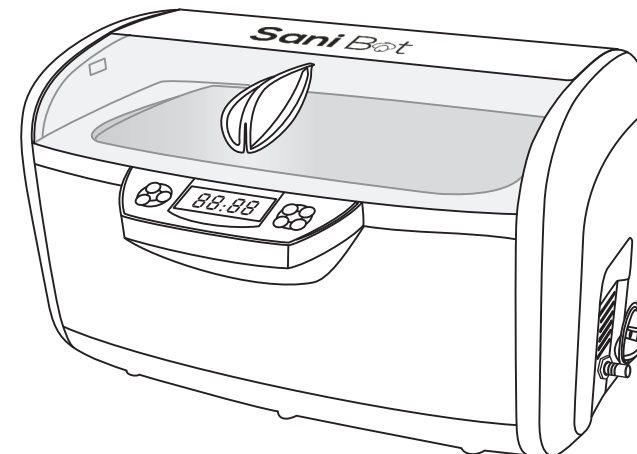

FEATURES

- ✓ Sleek Control Panel with Digital Display
- ✓ Heater Function for advanced disinfection
- ✓ Top Quality suited for at home use
- ✓ 1-30 minute full range timer
- ✓ 60 Powerful cleansing tablets (included)
- ✓ Basket that can also act as a Drying Station
- ✓ Stainless Steel Submersion Plate to keep floaty items submerged
- ✓ Stainless Steel Reservoir
- ✓ Drainage valve and hose for ease of use
- ✓ Premium Quality Transducers for super powerful cleaning

INTRODUCTION

Use tap water and Sani Bot cleansing tablets

How the Sani Bot works:

Millions of tiny air bubbles are generated inside the water and cleansing tablet solution by high frequency vibration. The air bubbles burst inside the liquid solution and shake off the debris on your CPAP equipment to achieve the best cleansing affect. Try it and see for yourself!



- Purified water or distilled water has the same cleaning effect as regular tap water for ultrasonic cleaning. Therefore using tap water is sufficient.

Main Features

- Tank opening 32.3 x 20.5 x 9.9 cm / 12.7" x 8.1" x 3.9". Longest item that can fit inside the tank is 34.0 cm / 13.4". 6,000 ml / 1.6 gallon tank capacity.
- 2 industrial grade ultrasonic transducers (2 x 60 W = 120 W), 2 ceramic heaters (2 x 150 W = 300 W).
- 2-color LED display. 1 to 30-minute full range timer. 5 temperature settings. Working status indicators. Degas feature.
- Independent control circuits and multiple circuit protections.
- Industrial grade IC. Moisture-proofed PCB. Cooling fan. Drainage valve. LED lights on both sides.

Read the Manual First

The manual should be carefully reviewed before starting to use the device. Warnings should be observed carefully. Please follow the manual for operations.

TABLE OF CONTENTS

Safety Precautions	1,2
Product Structure and Accessories	3
Control Panel and Operations	4
Quick Instructions for Cleaning your CPAP Accessories	5,6,7
Care and Maintenance	8
Contact Us	9
Warranty.....	9
Specifications	10

SAFETY PRECAUTIONS



Keep it away from children!

-  **This device is not intended for use by individuals including children with restricted physical, sensory or metal capacities or those with a lack of experience and/or knowledge, including children, unless they are supervised by an individual who is responsible for their safety or have received training in operating the device.**
- Please store the Sani Bot where it is not reachable by children.
- Danger to children! Danger for death through suffocation! Keep the packaging material away from children.



To prevent life-threatening electrical shock, please observe the following:



Danger of electrical shock! Do not use while bathing. Never immerse the device or the power cord in water or other liquid.

- Danger of electrical shock!** Never touch the power plug with wet hands, especially when inserting or removing the plug.
- Danger of electrical shock!** If the unit has fallen into water during operation, do not touch the unit. Remove the power plug from the socket first.
- Danger of electrical shock!** Do not spray water or liquid over the device.
- Never operate the device unattended.
- Follow the manual to operate the device.
- Do not use components unapproved by the manufacturer.
- When removing the power cord from the socket, grab the power plug not the cord.
- To protect the power cord from damage, do not cause it to get caught by things such as a cupboard door or a chair leg; do not drag across a hot surface.
- If there is damage to the power plug, cord, housing, or other parts of the device, do not use the device.
- Do not disassemble the device, except by professionals.
- If the unit is damaged, non-operational or has fallen into water, take it to a qualified service provider.
- Remove the power plug from the socket
 - if malfunction occurs
 - before cleaning the device
 - if the device is not going to be used for prolonged period
 - after each use (recommended)
- The installation of an earth leakage circuit breaker with a rated tripping current of no more than 30 mA provides further protection against an electrical shock. The installation should only be carried out by a trained electrician.
- The device may come with a polarized plug (one blade is wider than the other) for certain countries. As a safety feature, this plug will fit into a polarized outlet only one way. If the plug does not fit fully in an outlet, reverse the plug. If it still does not fit, contact a qualified electrician.

SAFETY PRECAUTIONS

To prevent fire hazards, please observe the following:

- Never block the vents on the device. Keep the vents free from lint, hair and other materials.
- Do not place the device on a soft surface, such as a bed or a couch, where the vents could be blocked.
- Observe the other warnings in the previous section.

Other observations:

- Do not operate the product without filling the tank with water. Running dry will damage the unit.
- Do not plug in the power cord before adding water to the tank. Do not fill the tank above the Max line to avoid overspill.
- Do not use solution containing abrasive substances or strong corrosive chemical solution not recommended by the manufacturer or the supplier.
- Place the device on a dry and flat surface for operation.
- When the device is subjected to severe electromagnetic interference, it may malfunction, stop operating or lose control functions. If this happens, unplug the power cord then reinsert it to restart the device.

PRODUCT STRUCTURE AND ACCESSORIES

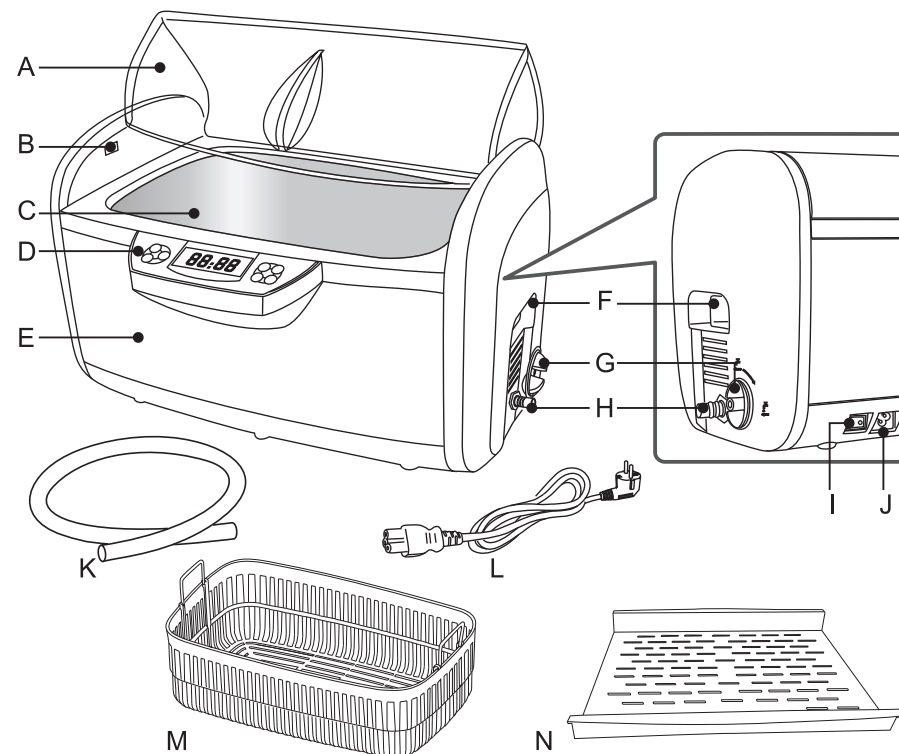

- A.** Lid **B.** LED lights **C.** Stainless steel tank **D.** Control panel
E. Housing **F.** Handles **G.** Drainage valve handle **H.** Drainage pipe
I. Power switch **J.** Power socket **K.** Hose **L.** Power cord
M. Plastic basket **N.** Stainless steel submersion plate

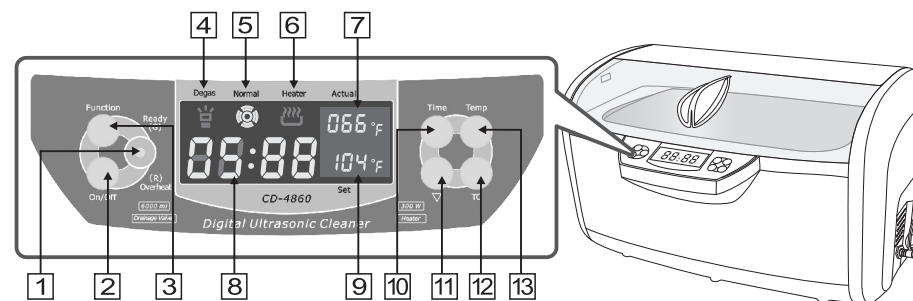

CONTROL PANEL AND OPERATIONS

1. Indicator Light - Working Status

Green – Ready (G): Normal working status, ready to use.



Red – Overheat (R): Under overheat protection. 15 minutes of waiting is needed for the light to change from red to green. Work can resume afterwards.

2. On/Off Button - On/Off Switch

After powering on, the LED displays  which is the default time and the unit is ready with normal working status.

Press On/Off button once and the cleaning starts. The cleaning stops when the timer counts down to **00:00**. If the unit needs to be stopped before the timer runs up, press On/Off button.

3. Function Button - Functions (Deep clean / Normal)

Press Function button,  illuminates, indicating deep clean function is selected. Press On/Off button to start deep cleaning.  will flash for 2 minutes, then the unit will return to the normal cleaning function. Pressing Function button before it ends will stop deep cleaning. If additional deep cleaning is needed after it ends, press Function button again.



4. — Deep clean

 — Illuminated, the deep clean function is selected.  — Flashing, deep cleaning is underway.

5. — Normal Cleaning Status

 — Illuminated, normal cleaning is underway.

6. — Heater Status

Press TC button,  flashes, indicating the heater is turned on. Press TC button again,  dims, indicating the heater is turned off.

7. Actual – Water temperature display. It displays the actual water temperature in the tank.

8. **05:00** Digital LED display of working time. It counts down after cycle has started.

9. Set – Set temperature display. Press Temp button to select one of the 5 set temperatures.

10. Time button — Timer quick set button. Press Time button, LED display shows **05:00**. Each pressing increases it by 5 minutes

11. button — Timer decreasing button. Each pressing reduces the timer by 1 minute.

12. TC button — Heater button. Pressing TC button, flashes, indicating the heater is turned on. To cancel heating, press TC. dims, indicating the heater is turned off.

When the water reaches the set temperature, the heater will turn off automatically.

The type of technology in these machines uses transducers to create ultrasound and this technology requires a ceramic heater. To avoid damage to the heater, do not add cold water when the heater is hot otherwise the ceramic may break due to large and fast temperature differences.

To avoid misusing the heater:

1. Don't drain dirty water out then add cold clean water when the heater is on.
2. Don't turn on the heater when the tank is empty. Heater can be damaged if it is run for more than 15 seconds without water in the tank.

Always turn off the heater before adding cold water. Make sure there is enough water in the tank before turning on the heater.

13. Temp button — Temperature set button. 5 set temperatures can be selected.

The default temperature is 104°F. Press Temp button to select the temperature in the following sequence: 104°F → 113°F → 122°F → 131°F → 140°F

Quick Instructions for Cleaning your CPAP Accessories

Scan this QR Code and watch the video to see instructions for using your Sani Bot as well as get all your questions answered!
(or go to h10.us/KpNIQR on your browser)

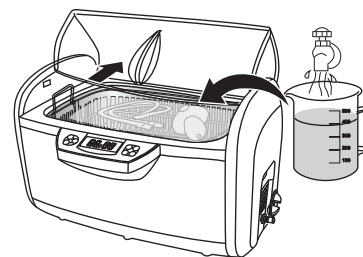

- 1 Turn your tap water on and wait till it gets hot. Remove the lid as illustrated. Place your CPAP equipment in the basket, and add hot tap water until equipment is fully covered, between the min and max lines. No need to take your mask apart. Submersion is all that's necessary for the oscillation to clean all the surfaces. For tubing, roll the tubing up small enough to fit inside the tank. For maximum cleaning effect, the entire hose needs to be submerged with no air inside the hose. Place the Submersion Plate on top of your CPAP equipment to keep it submerged while cleaning. The Sani Bot

also works with heated tubing. Make sure to disconnect the power for the tubing before cleaning, and make sure it is completely dry before next use because it is an electronic.

Do NOT turn the Sani Bot on without water in the tank. This will severely reduce the life of your Sani Bot.

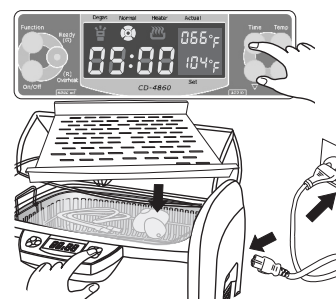

- 2 Add a Sani Bot cleansing tablet to the water. Connect the power cord and turn the switch on. The screen will show 5:00 as the default cleaning cycle time to start. 5:00 minutes may be enough for your mask, but for the first time using the machine, we recommend a 10-20 minute cycle. Going forward, you can select a time that is appropriate for how often you clean your mask. 5:00 is good if you clean your gear every day or every other day, but longer cleaning may be needed if you clean your gear weekly or bi-weekly. The time can be set from 1 to 30 minutes. Press the Time button to change the timer.

Prolonged cleaning times may be unnecessary and will shorten the life of your Sani Bot in the long run, so make sure to find the most suitable range of time for routine cleaning.

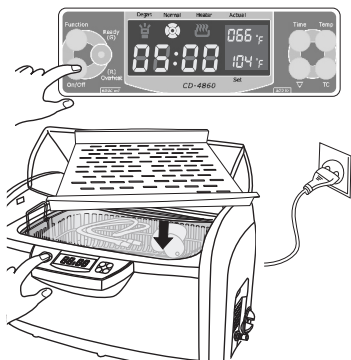

- 3** Press the Temp button to turn on the heater. Select the temperature you want to reach during the cleaning cycle from one of the 5 pre-sets (read the note below about the heater). The heater icon will blink to indicate it is turned on and working. Press the On/Off button to start cleaning. You'll hear a buzzing sound from inside the tank, indicating the cleaning is underway. Closing the lid will reduce the sound. The timer will count down to 0:00 and then turn off. You can turn it off at any time by pressing the On/Off button.

IMPORTANT note about the heater: The type of technology in these machines uses transducers to create ultrasound and this technology would damage a normal kitchenware heater. Kitchenware heaters heat up more quickly but are not compatible with this technology. We therefore use a special heater that can maintain and increase hot temperatures but it heats up slowly. For this reason, we recommend adding hot tap water to start with. Hot water is essential for effective cleaning. The Sani Bot will do an excellent job of cleaning with the temperature anywhere above 120 degrees. Most homes have the tap water temperature capped off around 115 degrees, so we recommend using hot tap water. There's a safety shutoff at 140 degrees Fahrenheit on the Sani Bot. Once it reaches 140 degrees, the heater will automatically turn off, but the cleaning will continue. It is not necessary to get the temperature to 140 for effective cleaning.

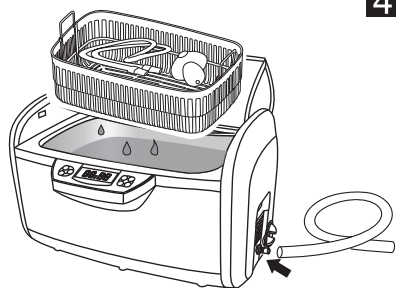

- 4** When cleaning is complete, use the drain to empty the water. **CAUTION:** Water may be very HOT! Do not touch the water. Rinse your CPAP equipment, tank, and basket with lukewarm tap water. This will remove any residue from the cleansing tablet formula. Next, use the submersion plate as a drying rack to dry mask. Place the rack inside the basket and allow the mask to air dry until next use. If any moisture remains by the time you need to use your mask again, you can simply hook it up to your CPAP machine and blow air through the mask for a few minutes. This should remove any remaining moisture.

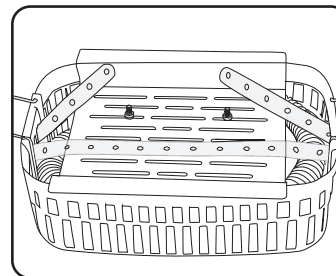

Optional: If your gear is still not fully submerged after placing the submersion plate on top, you can use the included bungee strap to aid in complete submersion.

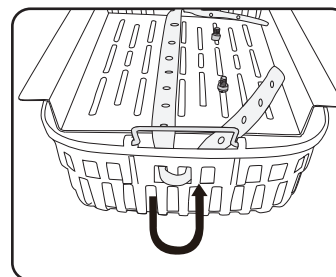

Step 1:

Place the bungee strap on top of the submersion plate and loop it through the left and right sides of the basket.

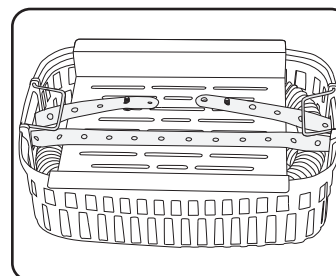

Step 2:

Pull each end of the strap towards the bolts on the submersion plate to the desired tightness and connect the holes of the bungee cord to the bolts.

Note: There is no need to remove or loosen the nut on the bolt. The bolt acts as a peg for the bungee to secure to.

CARE AND MAINTENANCE

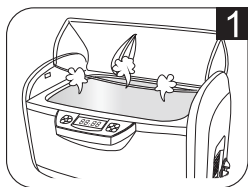

Do not turn on the unit without water in the tank.

Even though the unit is designed with multiple protections, if it is turned on for over 15 seconds without water in the tank, it may damage the unit or severely reduce the life of the unit.

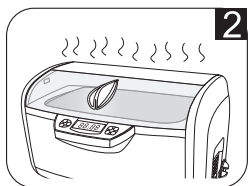

Do not run the unit for extended time or continuously.

The unit is designed with overheat protection. If the unit has been running for 45 minutes, it is recommended to stop the unit for about 20 minutes to prolong the life of the unit.

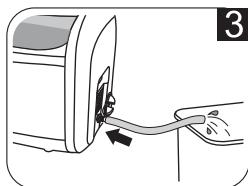

Do not keep water in the cleaning tank for a long time.

After cleaning is completed, open the drainage valve to drain the dirty water. Clean and wipe the tank dry.

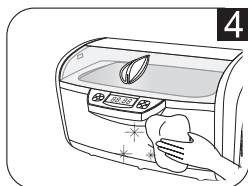

Do not spray water over the housing.

Use a towel to wipe the tank and the housing dry.

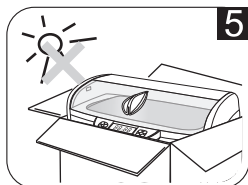

Do not expose the unit under direct sun shine for a long time.

Keep the unit in a dry, cool and ventilated area.

CONTACT US

We'd love to hear from you with any questions or comments! If anything is missing or defective we are also happy to help with that. Simply call us at (858) 333-6505 or email our friendly support team at support@sani-bot.com

WARRANTY

We hope everything turns out fantastic and our product is what you expected. Your satisfaction is our top priority. If you need anything at all we are here and so happy to help! Send us a message at support@sani-bot.com

Register your Warranty in under 2 minutes! Scan this code to get started.

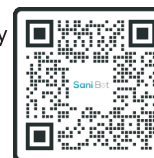

Scan takes you to Facebook Messenger. If you do not have Facebook Messenger, you can email us your name and order# to support@sanibot.com to register your warranty. Make sure to mention you are requesting warranty registration.

We would appreciate it so much if you'd like to leave an Amazon rating or review! Ratings only take 10 seconds and reviews just a minute or 2! Scan this code to do either:

